



6 Cardinal Drive, Aylesbury, HP18 0XD

£400,000



6 Cardinal Drive, Aylesbury, HP18 0XD

£400,000

This attractive chain free three bedroom semi detached home with garage and generous garden is located in the popular Berryfields development in Aylesbury.

The accommodation is well balanced across two floors and has been thoughtfully designed for modern family living.

On the ground floor there is a welcoming hallway with a guest cloakroom, a spacious sitting room to the front, and to the rear an impressive open plan kitchen and dining room. The kitchen is fitted with sleek white units and integrated appliances, while French doors lead directly to the garden, creating an excellent space for entertaining and day to day living.

Upstairs the main bedroom benefits from fitted wardrobes and a contemporary en suite shower room. There are two further bedrooms which can be used as family rooms, guest rooms or a home office, together with a stylish family bathroom finished in neutral tones.

The rear garden offers a good sized lawn and patio area with side access. To the front of the property there is driveway parking and a single garage.

Cardinal Drive is positioned within easy reach of schools, green spaces, and Aylesbury Vale Parkway station, providing convenient commuter links into London and surrounding areas.

Description



Situation



null
Council Tax Band: D
Available:

Floor Plans

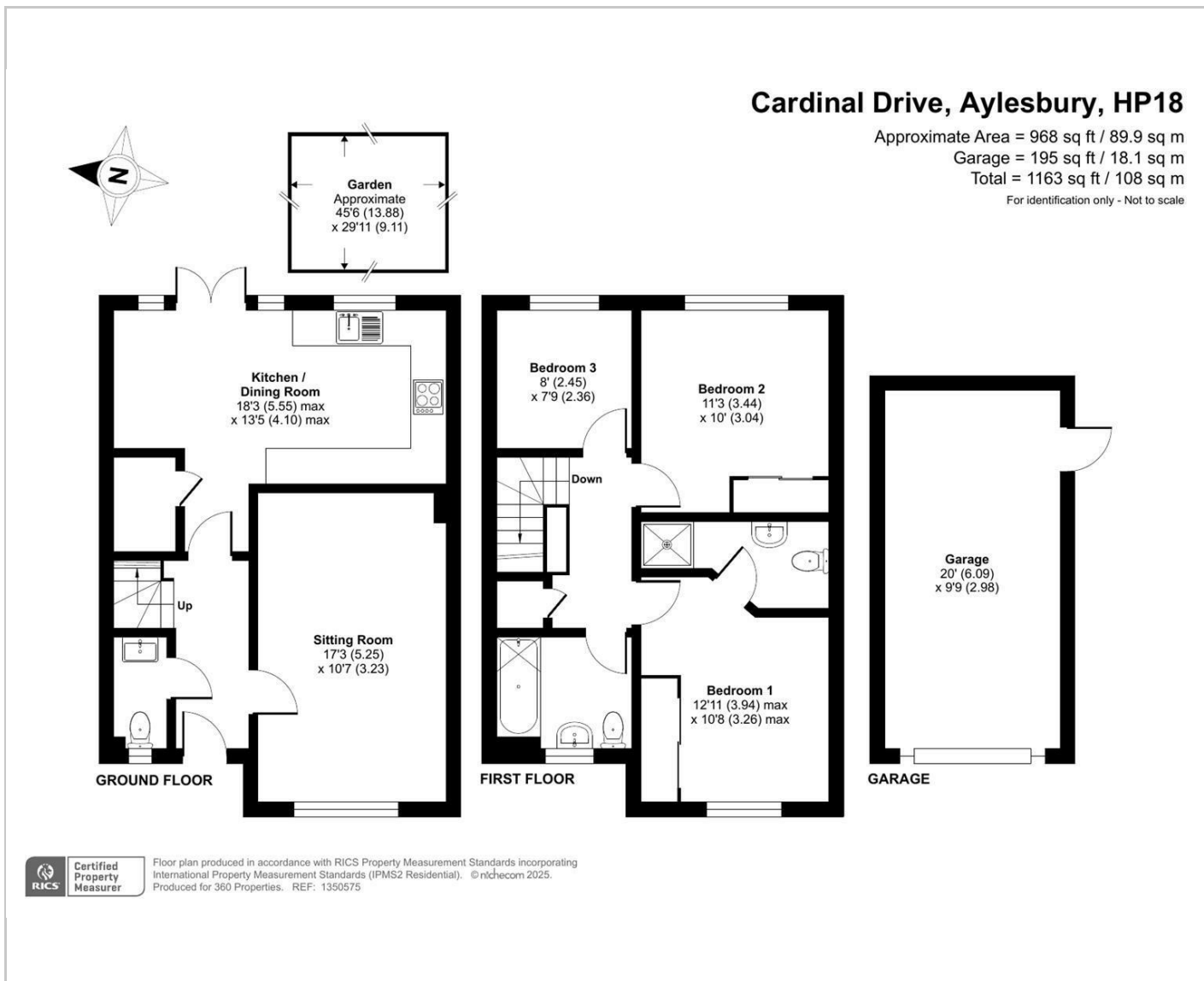

Area Map

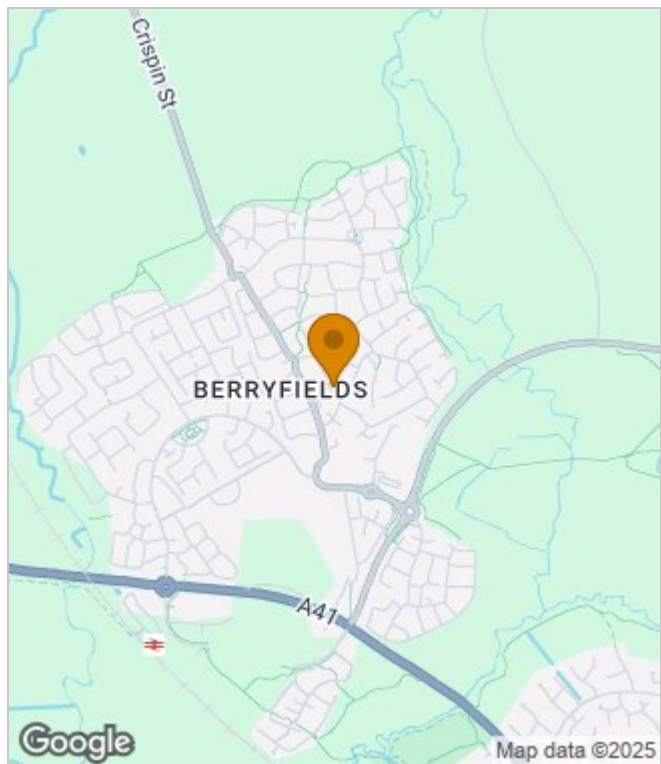

Energy Performance Graph

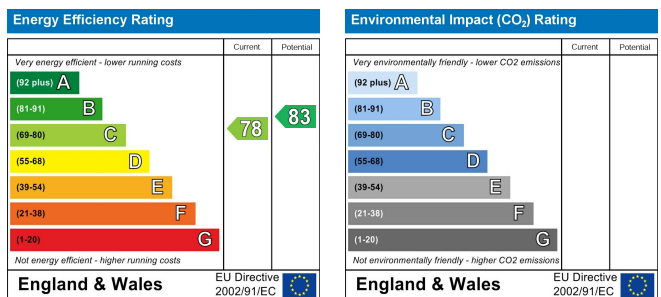

These particulars, whilst believed to be accurate are set out as a general outline only for guidance and do not constitute any part of an offer or contract. Intending purchasers should not rely on them as statements of representation of fact, but must satisfy themselves by inspection or otherwise as to their accuracy. No person in this firm's employment has the authority to make or give any representation or warranty in respect of the property.